

SCHEMATIC

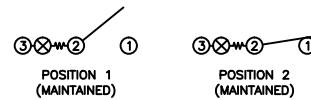

SPECIFICATIONS

FUNCTION:
1P1T OFF-ON

RATINGS:
ANSI/UL 1054 and CAN/CSA C22.2 No. 55 (E194579):
15A 125VAC [cURus]
7.5A 250VAC [cURus]

DIN 61058-1/VDE 0630-1:1993-05 (40017071):
16(4)A 250V~ 1E4 T125/55 [VDE]
16(6)A 250V~ 1E4 T125/55 [VDE]

ILLUMINATION VOLTAGE:
24V

CONTACT RESISTANCE:
Initial: 35mΩ Max. at 50VAC

INSULATION RESISTANCE:
100MΩ Min. at 500VDC

DIELECTRIC STRENGTH:
1,500VAC for 1 Minute

ELECTRICAL LIFE:
6,000 Cycles [cURus]
10,000 Cycles [VDE]

TEMPERATURE:
Operating: -20°C to 85°C [cURus]
Operating: -20°C to 125°C [VDE]



COLORS AND MARKINGS

BODY:
Black

ACTUATOR:
Transparent Green

MARKINGS:
None

MARKING COLOR:
None

MATERIALS

BODY:
Polyamide 6/6 (PA66), UL94 V-2

ACTUATOR:
Polycarbonate (PC), UL94 V-2

LAMP CARRIER:
Polyamide 6/6 (PA66), UL94 V-2

LAMP:
Incandescent Bulb

LAMP SPRING:
Steel

SPRING:
Steel

CONTACTS:
Silver Plated Copper

TERMINALS:
Silver Plated Copper
Brass

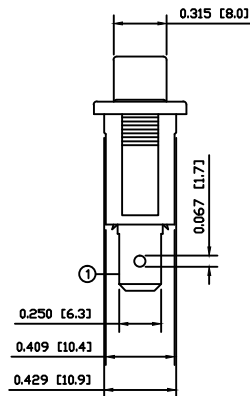
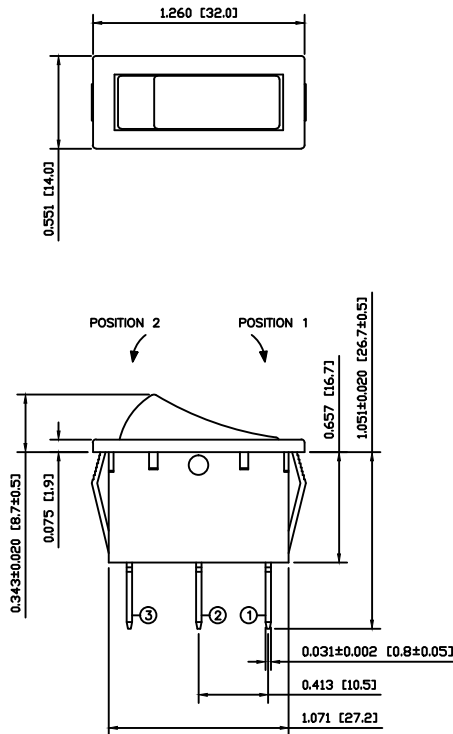

SUGGESTED PANEL CUTOUT

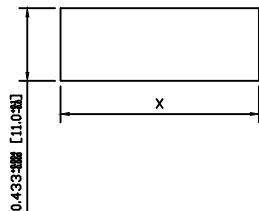

PANEL THICKNESS		X	
0.030~0.049	[0.75~1.25]	1.181	[30.0]
0.049~0.079	[1.25~2.00]	1.197	[30.4]
0.079~0.118	[2.00~3.00]	1.210	[30.7]

ACTUATOR	REV.	DATE	BY	CAB
A		09/06/29	MW	CAB
BODY		09/06/29	MW	CAB
COLORS		09/06/29	MW	CAB
MATERIALS		09/06/29	MW	CAB
SPECIFICATIONS		8/24/2015	MW	
REFERENCE				

THE INFORMATION CONTAINED IN THIS DOCUMENT IS PROPRIETARY TO E-SWITCH AND IS NOT TO BE COPIED OR TRANSFERRED

REV.	DESCRIPTION	DATE	BY
A	INITIAL RELEASE	21961	8/24/2015
		PCR	MW

DIMENSIONS	
INCHES [MILLIMETERS]	
GENERAL TOLERANCES	
±0.008 [±0.2] / ±1"	
SCALE	PROJECTION
DRAWING NOT TO SCALE	1st Angle

<p>TITLE</p> <p>RB141C1000-135</p>			
ITEM NUMBER	DATE	REVISION	
38-RB141C1000135	8/24/2015	A	