

NOTES:

1. METALSHELLS: STEEL; min. 315µm TIN over 40-80µm NICKEL
2. INSULATORS: PBT GF UL 94 V-0, BLACK
3. CONTACTS: COPPER ALLOY; PLATING (SEE PART NO.):
 - PLEASE ADD A for GOLD FLASH over NICKEL (PREFERRED TYPE)
 - PLEASE ADD B for 20µm HARD GOLD over min. 50µm NICKEL
 - PLEASE ADD C for 30µm HARD GOLD over min. 50µm NICKEL
 - PLEASE ADD J for 30µm HARD GOLD over min. 50µm NICKEL
4. THREADED SPACER CLIPS:
 - COPPER ALLOY; min. 200µm TIN over 80µm NICKEL
 - PCB-HOLE: $\phi 3.1 \pm 0,1$; PCB THICKNESS 1,6mm
5. COLLARS: COPPER ALLOY; min. 200µm TIN over 80µm NICKEL
6. P.C.B. HOLE DRILLINGS ON SHEET 2
7. MAXIMUM TORQUE VALUE FOR THREAD: 6 in.LB
8. CONNECTOR IS PART MARKED: 163□16179X CONEC ABC (see note 3)

Directive 2002/95/EC RoHS compliant

THIS DRAWING MAY NOT BE COPIED OR REPRODUCED IN ANY WAY, AND MAY NOT BE PASSED ON TO A THIRD PARTY WITHOUT WRITTEN PERMISSION. OWNERSHIP AND COPYRIGHT OF CONEC GmbH DO NOT ALTER CAD DRAWING BY HAND				tolerance		scale:	2:1 (5:1)		
				dim. in mm		material:	SEE NOTES		
				date	name	title: D-SUB MALE 25pos. SOLDER PIN STRAIGHT with threaded spacer clip			
				drawn	08.01.13				Henneboel
				appd.	09.01.13				Fischer
			norm				dwg no:	DIN-A3	
			d-old	16K1A1045/16K1A1201/16K1A681			(b) 16K1A3165 sh: 1/2		
			4 x b	A4593	08.01.2013	K.H.	part no: (b) 163□16179X (see note 3)		
			a	Original					
			rev.	description	date	name			



HOLE DRILLINGS

(P.C.B. TOP SIDE)

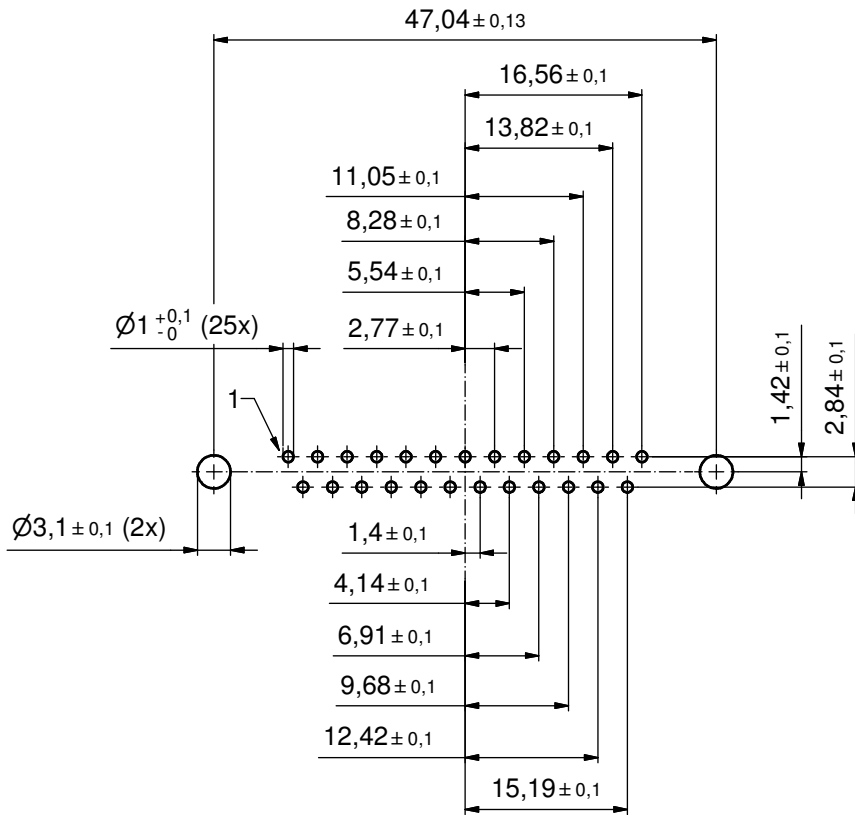

THIS DRAWING MAY NOT BE COPIED OR REPRODUCED IN ANY WAY, AND MAY NOT BE PASSED ON TO A THIRD PARTY WITHOUT WRITTEN PERMISSION. OWNERSHIP AND COPYRIGHT OF CONEC GmbH DO NOT ALTER CAD DRAWING BY HAND				tolerance		scale: 2:1	
				date	name	material: SEE SHEET 1	
				drawn	08.01.13 Henneboel	title: P.C.B. HOLE DRILLINGS D-SUB MALE 25.pos. SOLDER PIN with threaded spacer clip	
				appd.	08.01.13 Fischer		
				norm			
			d-old		dwg no:		
a	Original		CONEC [®]			16K1A3165	DIN-A3
rev.	description	date				name	part no: SEE SHEET 1