

**Technical specification:**

Rated voltage: IEC 61076-2-101	5pos 60 V
Current rating: IEC 61076-2-101	4 A at 40°C
Insulation resistance: IEC 60512	>=100 MΩ
Pollution degree: IEC 60664-1	3/2
Degree of protection: IEC 60529	IP 67, in mated condition
Temperature range: IEC 60664-1	-20°C ... +80°C
Mating cycles: IEC 60512-9a	>=100

**Materials:**

Contact:	CuZn
Contact plating:	Nickel, gold plated
Contact carrier:	TPU GF, UL 94
Sealing:	FPM
Coupling nut:	GD-Zn, nickel plated
Moulding body:	TPU, UL 94, grey

**Installation specification:**

Recommended torque:	0,6 Nm
Conec installation tool:	Torque wrench: 36-000200 Insert across flats 13: 36-000220

**Contact assignment:**

1)	shielding
2)	red (+)
3)	black (-)
4)	white (CAN H)
5)	blue (CAN L)

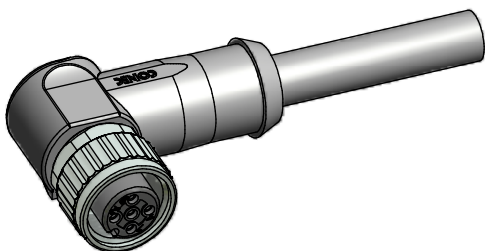

Part no:	Description:	Length L:	Cable:
43-12516	SAL - DN - 12 - RKW5.3 - 2 / GC	2m	PVC, UL, grey, 2xAWG22 + 2xAWG24 Cable: 781-GC001H
43-12517	SAL - DN - 12 - RKW5.3 - 3 / GC	3m	
43-12518	SAL - DN - 12 - RKW5.3 - 5 / GC	5m	
43-12519	SAL - DN - 12 - RKW5.3 - 10 / GC	10m	
43-xxxxx	SAL - DN - 12 - RKW5.3 - ... / GC	x	

D see data sheet cable

DO NOT ALTER CAD DRAWING BY HAND Directive 2002/95/EC RoHS compliant	Index: a 14.03.2011 VF Ä3767 Coupling nut modified, spanner flats added, data sheet modified	dim. in mm <table border="1"> <tr> <td></td> <td>date</td> <td>name</td> </tr> <tr> <td>drawn</td> <td>04.11.08</td> <td>Mankopf</td> </tr> <tr> <td>appd.</td> <td>04.11.08</td> <td>Fromm</td> </tr> </table>		date	name	drawn	04.11.08	Mankopf	appd.	04.11.08	Fromm	<b>title:</b> <b>Female connector M12x1 angled,          DeviceNet</b>
			date	name								
	drawn	04.11.08	Mankopf									
	appd.	04.11.08	Fromm									
tolerance of cable: L ≤ 4m: L + 40mm L > 4m: L + 1%		<b>dwg no:</b> <b>43K1A804</b>										
THIS DRAWING MAY NOT BE COPIED OR REPRODUCED IN ANY WAY, AND MAY NOT BE PASSED ON TO A THIRD PARTY WITHOUT WRITTEN PERMISSION. OWNERSHIP AND COPYRIGHT OF CONEC GmbH		<b>part no:</b> <b>see table</b>										