

# Printed-circuit board connector - PC 5/ 5-GF-7,62 - 1720822

Please be informed that the data shown in this PDF Document is generated from our Online Catalog. Please find the complete data in the user's documentation. Our General Terms of Use for Downloads are valid (<http://phoenixcontact.com/download>)

PCB headers, nominal current: 41 A, rated voltage (III/2): 630 V, number of positions: 5, pitch: 7.62 mm, color: green, contact surface: Tin, mounting: Wave soldering



The figure shows a 5-pos. version of the product

## Why buy this product

- Well-known mounting principle allows worldwide use
- Screwable flange for superior mechanical stability
- Maximum flexibility when it comes to device design – one header for connectors with different connection technologies

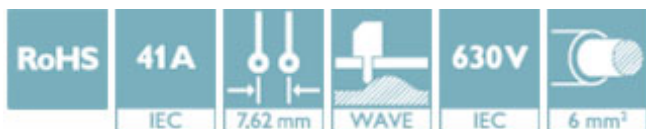

## Key Commercial Data

|              |               |
|--------------|---------------|
| Packing unit | 50 STK        |
| GTIN         |               |
| GTIN         | 4046356113625 |

## Technical data

### Dimensions

|                          |            |
|--------------------------|------------|
| Length [ l ]             | 29.25 mm   |
| Width                    | 54.2 mm    |
| Pitch                    | 7.62 mm    |
| Dimension a              | 30.48 mm   |
| Width [ w ]              | 54.2 mm    |
| Height [ h ]             | 19.29 mm   |
| Constructional height    | 14.29 mm   |
| Length of the solder pin | 5 mm       |
| Pin dimensions           | 0.8 x 1 mm |
| Pin spacing              | 7.62 mm    |
| Length                   | 29.25 mm   |

### General

# Printed-circuit board connector - PC 5/ 5-GF-7,62 - 1720822

## Technical data

### General

|                                        |             |
|----------------------------------------|-------------|
| Range of articles                      | PC 5/...-GF |
| Insulating material group              | I           |
| Rated surge voltage (III/3)            | 6 kV        |
| Rated surge voltage (III/2)            | 6 kV        |
| Rated surge voltage (II/2)             | 6 kV        |
| Rated voltage (III/3)                  | 630 V       |
| Rated voltage (III/2)                  | 630 V       |
| Rated voltage (II/2)                   | 1000 V      |
| Connection in acc. with standard       | EN-VDE      |
| Nominal current $I_N$                  | 41 A        |
| Maximum load current                   | 41 A        |
| Insulating material                    | PA          |
| Flammability rating according to UL 94 | V0          |
| Color                                  | green       |
| Number of positions                    | 5           |

### Standards and Regulations

|                                        |        |
|----------------------------------------|--------|
| Connection in acc. with standard       | EN-VDE |
|                                        | CUL    |
| Flammability rating according to UL 94 | V0     |

### Environmental Product Compliance

|            |                                                         |
|------------|---------------------------------------------------------|
| China RoHS | Environmentally friendly use period: unlimited = EFUP-e |
|            | No hazardous substances above threshold values          |

## Drawings

Drilling diagram

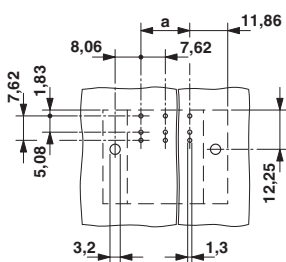

Diagram

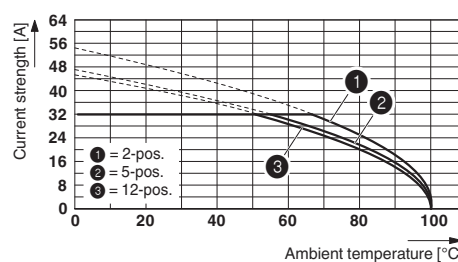

Type: PC 5/...-STF1-7,62 with PC 5/...-GF-7,62  
 Conductor cross section: 6 mm<sup>2</sup>

# Printed-circuit board connector - PC 5/ 5-GF-7,62 - 1720822

Diagram

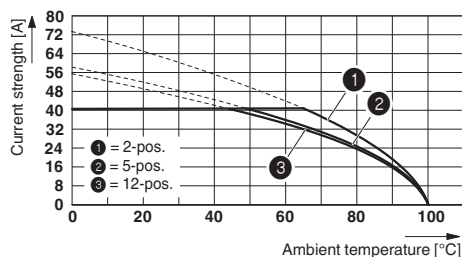

Dimensional drawing

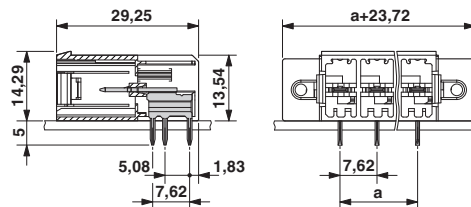

Type: PC 5/...-STF1-7,62 with PC 5/...-GF-7,62  
 Conductor cross section: 10 mm<sup>2</sup>

## Approvals

### Approvals

Approvals

EAC / cULus Recognized

Ex Approvals

### Approval details

|     |  |         |
|-----|--|---------|
| EAC |  | B.01742 |
|-----|--|---------|

|                  |  |                                                                                                                                                       |                 |
|------------------|--|-------------------------------------------------------------------------------------------------------------------------------------------------------|-----------------|
| cULus Recognized |  | <a href="http://database.ul.com/cgi-bin/XYV/template/LISEXT/1FRAME/index.htm">http://database.ul.com/cgi-bin/XYV/template/LISEXT/1FRAME/index.htm</a> | E60425-19920722 |
|------------------|--|-------------------------------------------------------------------------------------------------------------------------------------------------------|-----------------|

|                    | D     | B     | C     |
|--------------------|-------|-------|-------|
| Nominal voltage UN | 600 V | 300 V | 150 V |
| Nominal current IN | 5 A   | 41 A  | 41 A  |

Phoenix Contact 2018 © - all rights reserved  
<http://www.phoenixcontact.com>

PHOENIX CONTACT GmbH & Co. KG  
 Flachsmarktstr. 8  
 32825 Blomberg  
 Germany  
 Tel. +49 5235 300  
 Fax +49 5235 3 41200  
<http://www.phoenixcontact.com>