

A

PANDUIT PART NUMBER	WEIGHT
FROV4512X4	0.72 LB/EACH (325g/EACH)

D

E NOTES:

1. SEE CURRENT CATALOG FOR ADDITIONAL PART SUFFIXES TO INDICATE COLOR AND/OR PACKAGE QUANTITY.
2. THE FIBERRUNNER 12x4 OUTSIDE VERTICAL 45° ANGLE FITTING IS DESIGNED WITH A MINIMUM 2" (50.8) BEND RADIUS TO PROTECT FIBER OPTIC CABLES.
3. DIMENSIONS IN PARENTHESES ARE IN METRIC.

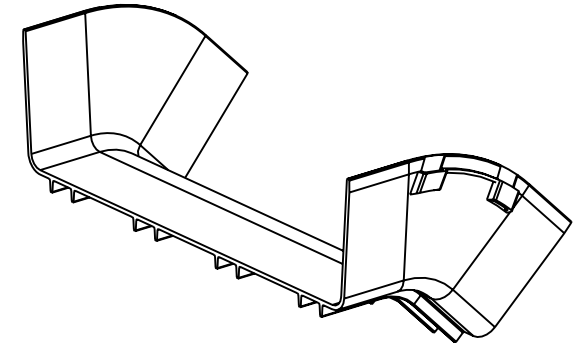
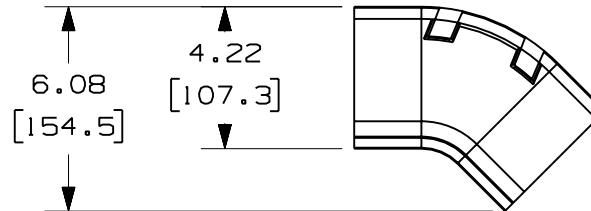
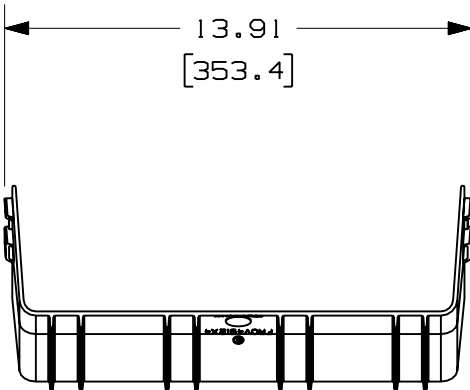
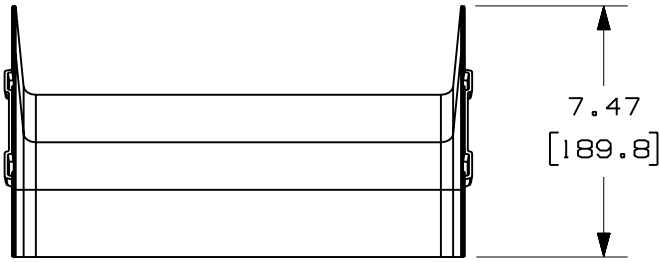

ENG. REF.: D37617CC\_DC\_FROV4512X4\_01.prt

CAD FILENAME/LAYERS: C FROV4512X4.pdf

PANDUIT CORP TINLEY PARK, ILLINOIS  
 FIBERRUNNER 12x4 OUTSIDE VERTICAL  
 45° ANGLE FITTING (FROV4512X4)  
 CUSTOMER DRAWING

UNLESS OTHERWISE SPECIFIED, DIMENSIONAL TOLERANCES ARE:

(.X) ± (.XXX) ±  
 (.XX) ± .03 (.8) ANGLES ±

UNLESS OTHERWISE SPECIFIED, ALL DIMENSIONS ARE GIVEN IN INCHES, THIRD ANGLE PROJECTION.

DRAWN BY: JHNU

MAT'L:

SCALE: NONE

DATE: 1-5-01

CHK'D: LD

ABS

DRAWING NO.: 37617-82

DWG SIZE: A

REV	DATE	BY	CHK	DESCRIPTION	ECN	R	CUST	SUP	GMBH
-	-----	---	---	E. REVISED GENERAL NOTES	-----	--	--		
-	-----	---	---	D. REVISED PART WEIGHT C. REVISED CAD FILENAME	-----	--	--		
1	7-7-06	DTP	RN	B. REVISED DRAWING TITLE A. REVISED AND REDRAWN	37617-82	RN	RN		