

4850, 6-pole, Plug, solder terminal, DIN Plug/Socket



### Description

- Solder terminal :  
for cable mounting
- DIN Plug: 6-pole , straight

### Technical Data

Diameter	9.0 mm	Allowable Operation Temperature	-20 °C to 70 °C
Number of Poles	6-pole	Terminal	solder terminal silver plated
Ratings DC	2 A / 12 VDC	Lifetime	5000 Insertions
Ratings AC	1 A / 100 VAC		
Dielectric Strength	250 VAC		
Insulation Resistance	> 50 MΩ @ 250 VDC		

Detailed information on product approvals, code requirements, usage instructions and detailed test conditions can be looked up in [General Product Information](#)

### Dimensions

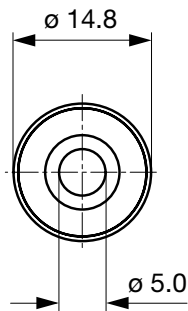

Cable diameter max. 5.0 mm

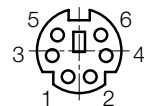
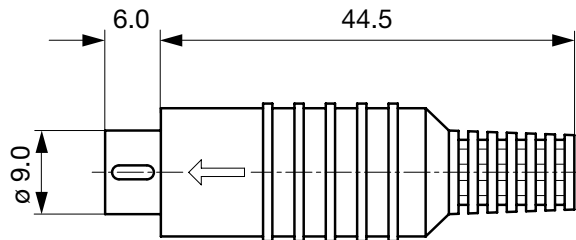

### All Variants

Product group	Diameter [mm]	Number of Poles	Terminal	Order Number
DIN Plug/Socket	9.0	6-pole	solder terminal	4850.1610

Most Popular.

Availability for all products can be searched real-time: <http://www.schurter.com/en/Stock-Check/Stock-Check-SCHURTER>

**Packaging unit** 100 Pcs

## Mating Outlets/Connectors

### Category / Description



[DIN Plug/Socket Overview complete](#)

4850, 6-pole, Socket, PCB terminals, DIN Plug/Socket	4850.2600
--	-----------

4850, 6-pole, Socket, PCB terminals, DIN Plug/Socket	4850.2610
--	-----------

4850, 6-pole, Line Socket, solder terminal, DIN Plug/Socket	4850.3600
---	-----------

[DIN Plug/Socket further types to 4850.1610](#)