

THIS DRAWING IS A CONTROLLED DOCUMENT FOR ELECTRONICS. ANY CHANGES MUST BE MADE IN ACCORDANCE WITH THE CONTROLLING DOCUMENT. CONTROL CENTER SHOULD BE CONTACTED FOR THE LATEST REVISION.

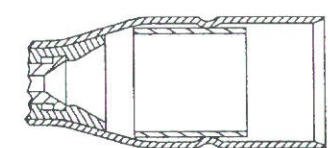
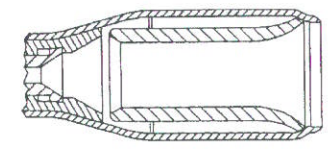
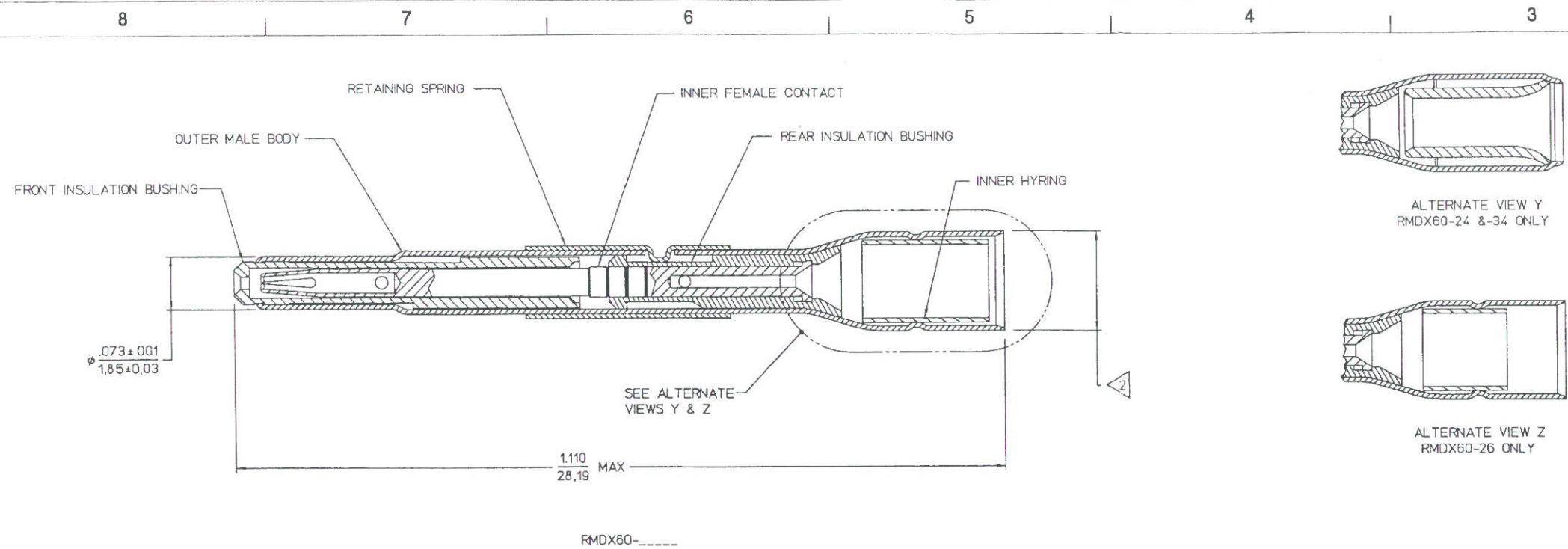

NOTES: UNLESS OTHERWISE SPECIFIED;
 1. INTERPRET THIS DRAWING IN ACCORDANCE WITH ANSI Y14.5M-1982.

- ENGINEERING REQUIREMENTS:
- THERE SHALL BE NO ARCING OR FLASHOVER WHEN A 450 VAC(RMS) IS APPLIED BETWEEN THE INNER AND OUTER CONTACTS IN THE FOLLOWING MANNER: VOLTAGE TO INCREASE FROM 0-450 VAC AT A RATE OF 100 VOLTS PER SECOND AND THEN MAINTAINED FOR ONE MINUTE. THIS IS A DESTRUCTIVE TEST.
 - AFTER CRIMPING A TERMINATED CONTACT MUST PASS THROUGH A $.1270 \pm .0002$ [3.226 $\pm .0005$] DIA X .750 [19.05] THK RING GAGE WITH A 5 LB. MAX. FORCE
 - THE INNER MALE CONTACT IS TO BE RECESSED WITHIN THE OUTER FEMALE BODY A MINIMUM OF .005 [0.13] BEFORE CRIMPING AND .005 [0.13] TO .040 [1.02] AFTER CRIMPING.
 - CONTACT RETENTION AFTER 5 INSERTION AND WITHDRAWAL CYCLES SHALL BE 15 LBS. MINIMUM.
 - ORANGE PEELING DUE TO CRIMPING IS ACCEPTABLE.
 - WIRE ACCOMMODATIONS SEE SHEET 2.

C

D

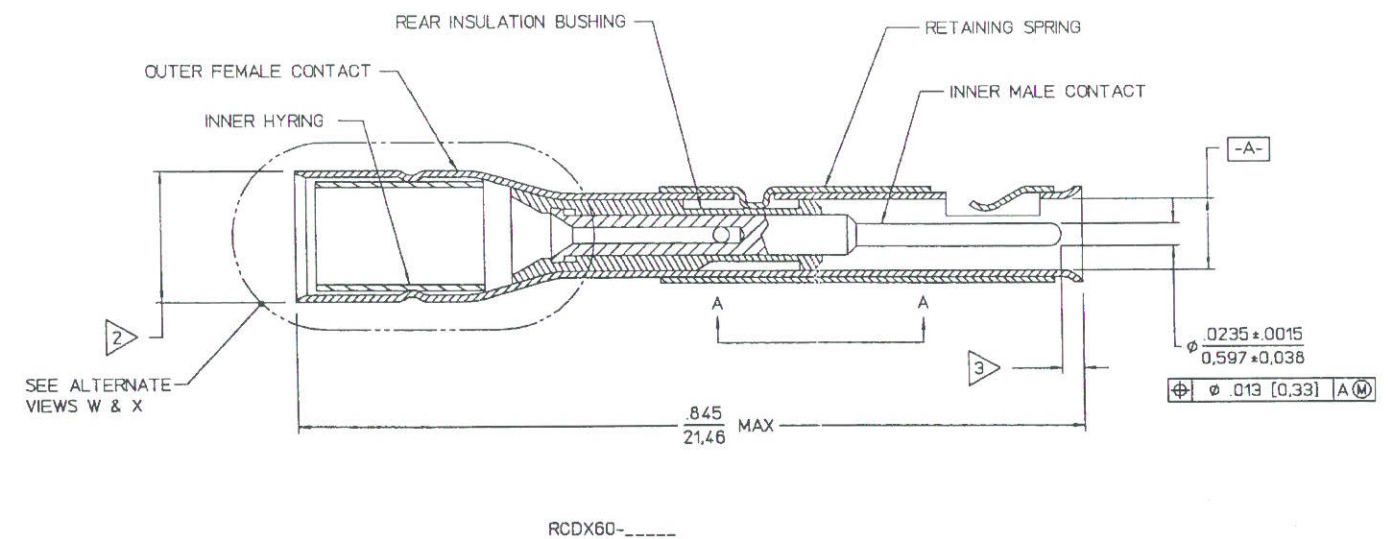
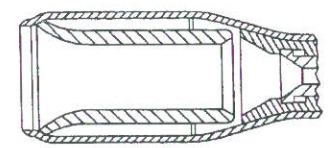
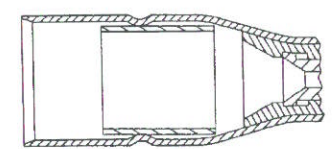

MATERIAL:
 OUTER CONTACTS- BRASS PER FED SPEC QQ-B-626
 INNER CONTACTS- BRASS PER FED SPEC QQ-B-626 OR BERYLLIUM COPPER PER FED SPEC QQ-C-533
 FRONT INSULATION BUSHING- NYLON, COLOR-RED
 REAR INSULATION BUSHING- NYLON, COLOR-NATURAL
 RETAINING SPRING- BERYLLIUM COPPER PER FED SPEC QQ-C-533
 INNER HYRING- BRASS PER FED SPEC QQ-B-626

FINISH:
 CONTACTS- SEE PLATING TABLE
 RETAINING SPRING- NICKEL PLATED
 INNER HYRING- SOLDER PLATED

B

B

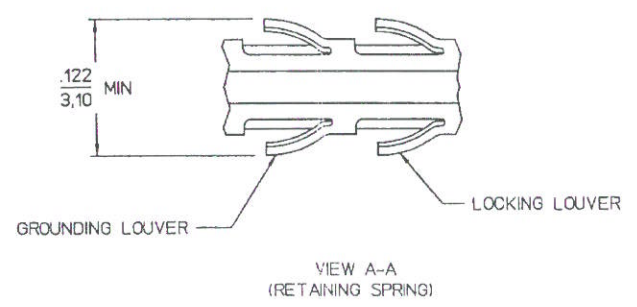
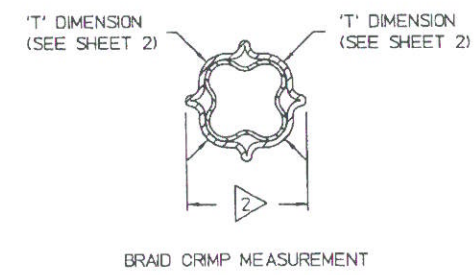
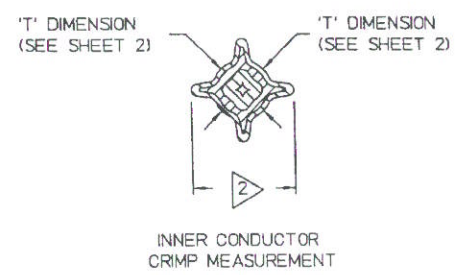

SUPERSEDES SD76413-30

REV	DESCRIPTION	BY	DATE	CHKD	DATE	SHEET	ZONE
34	RAYCHEM 5026R14 AWG SIZE 26 WAS 083. OUTER JACKET 083 N24 WAS 197.005 L100 C15019010502. OUTER JACKET 087 WAS 083. INNER CONDUCTOR SIZE 7/.0067 WAS 197.005. (ECN 4362)	SAF	8-23-99	DAF	8-23-99	SHEET NO.2	ZONE
33	ADDED RAYCHEM 5026R14 & L100 15013010902 CABLE PER (ECN 4355)	DAF	8-28-99	SH	8-28-99	SHEET NO.2	ZONE
32	ADDED CONN AWG SIZE 24 CA W/RAYCHEM 5024A3111.1 & DIMS. PER (ECN 3351)	SAF	7-29-99	RKS	7-29-99	SHEET NO.	ZONE
31	REDRAWN ON E SIZE NO CHANGE (ECN3155)	NET	12-16-94	RKS	12-16-94	SHEET NO.	ZONE

MONOCORP SUBMIN COAX CONTACTS

CAT NO. RC/RMDX60- (SEE TABLE)

FCI Electronics Systems Division

SOURIAU

SE76413 34

SHEET 1 OF 3

THIS DRAWING IS A CONTROLLED DOCUMENT AND SHOULD BE USED IN CONJUNCTION WITH THE CONTROLLING DOCUMENT. ANY CHANGES MUST BE MADE IN ACCORDANCE WITH THE CONTROLLING DOCUMENT. CONTROL CENTER SHOULD BE CONTACTED FOR THE LATEST REVISION.

A

THIS DRAWING IS THE PROPERTY OF FCI ELECTRONICS, INC. IT IS TO BE USED ONLY FOR THE PURPOSES AND IN THE QUANTITIES SPECIFIED IN THE ORDER. IT IS NOT TO BE REPRODUCED OR TRANSMITTED IN ANY FORM OR BY ANY MEANS, ELECTRONIC OR MECHANICAL, INCLUDING PHOTOCOPYING, RECORDING, OR BY ANY INFORMATION STORAGE AND RETRIEVAL SYSTEM, WITHOUT THE WRITTEN PERMISSION OF FCI ELECTRONICS, INC.

8 7 6 5 4 3 2 1

WIRE ACCOMMODATION TABLE											INSTALLATION TOOLING DATA (USE M10S, BM10S)							
INNER CONDUCTOR AWG SIZE	CABLE	OUTER JACKET MAX DIA (φD)	DIELECTRIC DIA (φ F)	INNER CONDUCTOR SIZE (φ G)	OUTER BRAID DIA (φ E)	CABLE STRIP LENGTH			COAX CONTACT ASSEMBLY (SEE PLATING TABLE SHT 2)		DIE SET	STOP BUSHING	INNER CONDUCTOR CRIMP		BRAID CRIMP		MIN INNER PULL OUT AFTER CRIMPING	MIN BRAID PULL OUT AFTER CRIMPING
						A	B	C	MALE	FEMALE			G DIM	T DIM	G DIM	T DIM		
30	CDC PIN 22939200	.090 [2.29]	.048 [1.22]	7/004 .012 [0.30] DIA	.064 [1.63]	.165 [4.19]	.235 [5.97]	.335 [8.51]	RMDX60-46	RCDX60-16	S-87	SL-105	.051/.046 [1.30/1.17]	.055/.048 [1.40/1.22]	.109/.104 [2.77/2.64]	.119/.112 [3.02/2.84]	4.1 LBS.	18 LBS.
30	CDC PIN 22939200	.090 [2.29]	.048 [1.22]	7/004 .012 [0.30] DIA	.064 [1.63]	.165 [4.19]	.235 [5.97]	.335 [8.51]	RMDX60-50	RCDX60-16	S-87	SL-105	.051/.046 [1.30/1.17]	.055/.048 [1.40/1.22]	.109/.104 [2.77/2.64]	.119/.112 [3.02/2.84]	4.1 LBS.	18 LBS.
30	CDC PIN 245670000	.104 [2.64]	.067 [1.70]	7/004 .012 [0.30] DIA	.083 [2.11]	.200 [5.08]	.250 [6.35]	.350 [8.89]	RMDX60-50	RCDX60-16	S-80	SL-105	.051/.046 [1.30/1.17]	.055/.048 [1.40/1.22]	.117/.112 [2.97/2.84]	.123/.116 [3.12/2.95]	4.1 LBS.	18 LBS.
30	KX21TVT (EUROPE) RG176 B/U	.075 [1.91]	.034 [0.86]	7/004 .012 [0.30] DIA	.054 [1.37]	.200 [5.08]	.250 [6.35]	.350 [8.89]	RMDX60-34	RCDX60-34	S-84	SL-105	.051/.046 [1.30/1.17]	.052/.046 [1.32/1.17]	.112/.108 [2.84/2.74]	.121/.114 [3.07/2.90]	4.7 LBS.	11 LBS.
30	RG178 B/U	.075 [1.91]	.034 [0.86]	7/004 .012 [0.30] DIA	.054 [1.37]	.200 [5.08]	.250 [6.35]	.350 [8.89]	RMDX60-50	RCDX60-16	S-87	SL-105	.051/.046 [1.30/1.17]	.055/.048 [1.40/1.22]	.109/.104 [2.77/2.64]	.119/.112 [3.02/2.84]	4.1 LBS.	8 LBS.
28	AMPEX	.114 [2.90]	.075 [1.91]	7/005 .015 [0.38] DIA	.090 [1.29]	.200 [5.08]	.250 [6.35]	.460 [11.68]	RMDX60-32	RCDX60-32	S-80	SL-105	.051/.046 [1.30/1.17]	.055/.048 [1.40/1.22]	.117/.112 [2.97/2.84]	.123/.116 [3.12/2.95]	3.7 LBS.	18 LBS.
26	T.I. PN 920580	.070 [1.78]	.038 [0.96]	7/0063 .019 [0.48] DIA	.054 [1.37]	.200 [5.08]	.250 [6.35]	.350 [8.89]	RMDX60-24	RCDX60-24	S-82	SL-105	.053/.047 [1.35/1.19]	.056/.050 [1.42/1.27]	.113/.108 [2.87/2.74]	.121/.114 [3.07/2.90]	5.8 LBS.	14 LBS.
26	RG174/U	.115 [2.92]	.060 [1.52]	7/0063 .019 [0.48] DIA	.088 [2.24]	.200 [5.08]	.250 [6.35]	.460 [11.68]	RMDX60-32	RCDX60-32	S-80	SL-105	.051/.046 [1.30/1.17]	.055/.048 [1.40/1.22]	.117/.112 [2.97/2.84]	.123/.116 [3.12/2.95]	8.0 LBS.	14 LBS.
26	HONEYWELL PN 58000062	.120 [3.05]	.077 [1.96]	7/0063 .016 [0.41] DIA SOLID	.096 [2.44]	.200 [5.08]	.250 [6.35]	.350 [8.89]	RMDX60-26	RCDX60-26	S-82	SL-105	.053/.047 [1.35/1.19]	.056/.050 [1.42/1.27]	.113/.108 [2.87/2.74]	.121/.114 [3.07/2.90]	10.5 LBS.	18 LBS.
26	RG188A/U	.110 [2.79]	.060 [1.52]	7/0067 .020 [0.51] DIA	.078 [1.98]	.200 [5.08]	.250 [6.35]	.460 [11.68]	RMDX60-36	RCDX60-36	S-80	SL-105	.051/.046 [1.30/1.17]	.055/.048 [1.40/1.22]	.117/.112 [2.97/2.84]	.123/.116 [3.12/2.95]	10.5 LBS.	18 LBS.
26	RG316/U	.107 [2.72]	.060 [1.52]	7/0067 .020 [0.51] DIA	.078 [1.98]	.200 [5.08]	.250 [6.35]	.460 [11.68]	RMDX60-36	RCDX60-36	S-80	SL-105	.051/.046 [1.30/1.17]	.055/.048 [1.40/1.22]	.117/.112 [2.97/2.84]	.123/.116 [3.12/2.95]	10.5 LBS.	18 LBS.
26	PRD PN 247AS-C1123-001	.103 [2.62]	.060 [1.52]	7/0067 .020 [0.51] DIA	.078 [1.98]	.200 [5.08]	.250 [6.35]	.350 [8.89]	RMDX60-18	RCDX60-18	M10S08 ASSY TOOL DIE SET STOP BUSHING M10S-1 TOOL		.048/.046 [1.22/1.17]	.053/.048 [1.35/1.22]	.115/.110 [2.92/2.79]	.123/.117 [3.12/2.97]	10.5 LBS.	18 LBS.
24	PRD PN 247AS-C1251	.092 [2.34]	.050 [1.27]	19/005 .025 [0.64] DIA	.067 [1.70]	.200 [5.08]	.250 [6.35]	.350 [8.89]	RMDX60-18	RCDX60-18	M10S08 ASSY TOOL DIE SET STOP BUSHING M10S-1 TOOL		.048/.046 [1.22/1.17]	.053/.048 [1.35/1.22]	.115/.110 [2.92/2.79]	.123/.117 [3.12/2.97]	9.0 LBS.	18 LBS.
24	RAYCHEM 5024A3111	.120 [3.05]	.083 [2.11]	19/005 .025 [0.64] DIA	.097 [2.46]	.200 [5.08]	.250 [6.35]	.460 [11.68]	RMDX60-52	RCDX60-52	S-88	SL-105	.054/.050 [1.37/1.27]	.057/.052 [1.45/1.32]	.115/.110 [2.92/2.79]	.117/.112 [2.97/2.84]	9.0 LBS.	20 LBS.
26	RAYCHEM 5026E1614	.083 [2.11] NOM.	.050 [1.27]	7/0067 .019 [0.48] DIA	.067 [1.70]	.200 [5.08]	.250 [6.35]	.350 [8.89]	RMDX60-36	RCDX60-36	M10S08 ASSY TOOL DIE SET STOP BUSHING M10S-1 TOOL		.048/.046 [1.22/1.17]	.053/.048 [1.35/1.22]	.115/.110 [2.92/2.79]	.123/.117 [3.12/2.97]	12.5 LBS.	8.1 LBS.
26	JUDD C15013010902	.087 [2.13]	.050 [1.27]	7/0067 .019 [0.48] DIA	.066 [1.67]	.200 [5.08]	.250 [6.35]	.350 [8.89]	RMDX60-36	RCDX60-36	M10S08 ASSY TOOL DIE SET STOP BUSHING M10S-1 TOOL		.048/.046 [1.22/1.17]	.053/.048 [1.35/1.22]	.115/.110 [2.92/2.79]	.123/.117 [3.12/2.97]	12.5 LBS.	9.6 LBS.

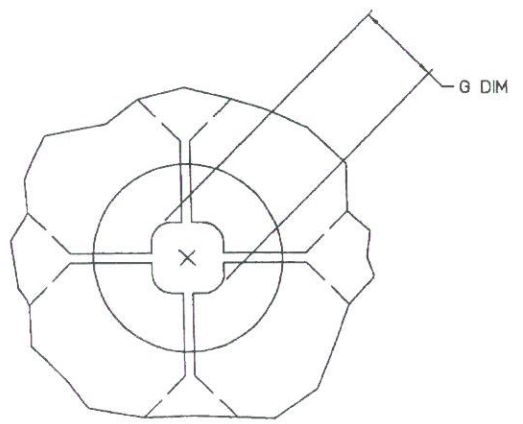

BRAID CRIMP (G DIM) TO BE MEASURED WITH DIE SET FULLY CLOSED

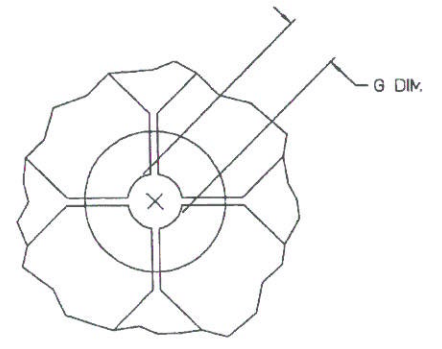

INNER CONDUCTOR CRIMP (G DIM) TO BE MEASURED WITH DIE SET FULLY CLOSED

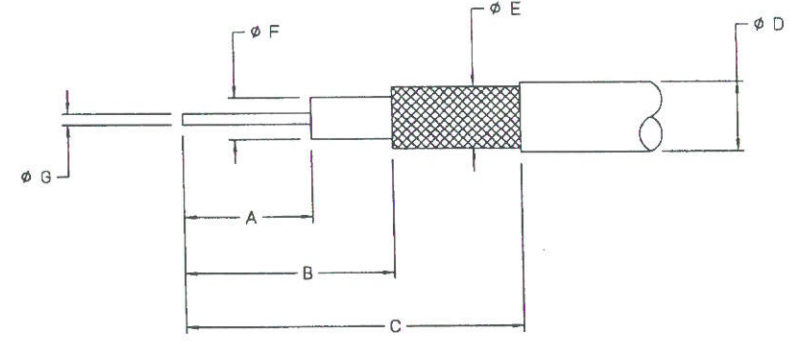

WIRE DIMENSIONS

REV	DESCRIPTION	BY DATE	CHKD DATE	SHEET NO.	ZONE
REVISION					
MONOCRIMP SUBMIN COAX CONTACTS					
CAT NO. RC/RMDX60-... (SEE TABLE)					
DWG RELEASED TO CENTRAL FILE					
GAGE NO. ECN 3158 P.O. 828 SIZE: D					
FCI Electronics Systems Division					
SOURIAU					
LINEAR MEASURE INCH (mm) THIRD ANGLE PROJECTION TOLERANCES UNLESS OTHERWISE SPECIFIED ONE PLACE .1 INCH (2.54) TWO PLACES .005 INCH (.127) THREE PLACES .0005 INCH (.0127) ANGLES 1/2°		DRAWN: POP 12-18-73 CHKD: LAS 11-12-74 DESGN: LAS 11-12-74 MFG: M0 12-22-84 DC: 84 12-22-74 DRAWING SCALE: NONE DRAWING NO. REV SE76413 34 SHEET 2 OF 3		APPROVAL:	

THIS DRAWING IS THE PROPERTY OF FCI ELECTRONICS, INC. IT IS TO BE USED ONLY FOR THE PURPOSES AND IN THE QUANTITIES SPECIFIED IN THE ORDER. IT IS NOT TO BE REPRODUCED OR TRANSMITTED IN ANY FORM OR BY ANY MEANS, ELECTRONIC OR MECHANICAL, INCLUDING PHOTOCOPYING, RECORDING, OR BY ANY INFORMATION STORAGE AND RETRIEVAL SYSTEM, WITHOUT THE WRITTEN PERMISSION OF FCI ELECTRONICS, INC.

8 7 6 5 4 3 2 1

