

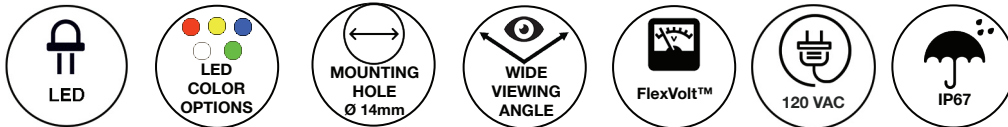

CNX714 Series 0.551" (14mm) Ruggedized LED Panel Mount Indicator



Ruggedized CNX714 Series with built-in LED offers fast, easy installation in harsh environments.



Applications

- Industrial Machinery
- Transportation Dashboards
- Instrument Panels
- Control Cabinets
- Safety Applications
- Disinfection and Sterilization
- Switching Stations
- Slot, Gaming and Vending Machines
- Outdoor Signs
- Military Aircraft

Key Features

- For panel hole diameter: 0.551" (14mm)
- Designed for extreme harsh and outdoor environments.
- Variety of connection options for fast, easy installation.
- Built-in LED can be used with FlexVolt™ (5 to 28 VDC) or 120VAC circuits
- Fast pitch threads ease assembly, requiring only one turn.
- Nut assembly by finger-tightening or with 1 inch hex key.
- Outdoor visibility in direct sunlight.
- Available in six solid colors (red, green, white, blue, soft yellow and yellow).
- Wide Viewing Angle
- Resistant to shock and vibration.
- Moisture sealed, IP67, protected from total dust ingress and withstanding water immersion between 15 cm and 1 meter for 30 minutes.
- Lead wire options with custom wire length available.
- Other colors (single or bicolor) are available upon request.
- RoHS and REACH Compliant.

Ordering Data

The CNX714 Series is available in a range of standard features and options. To specify your Panel Mount Indicator, select one option from each column.

LED Color		Voltage		Termination Style	
CNX714C				W	
CNX714C: Colored Body					
200	Red			W Wire Leads	
400*	Soft Yellow				
401	Yellow				
500	Green				
600	Blue	FV	5-28VDC		
900	White	120	120VAC		

Example:
CNX714C600120W
Blue
120VAC
Wire Leads



* Not Available for the 120VAC Version

Product Dimensions

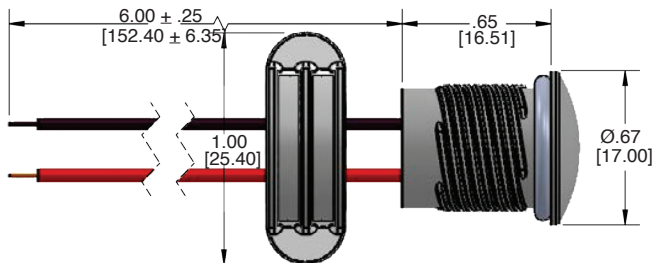

Recommended Mounting Hole

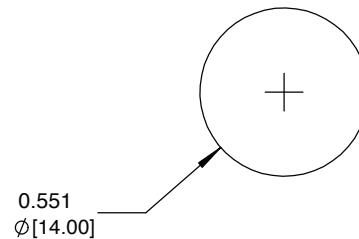

All Dimensions in inches [mm]

Tolerances are: ± 0.01 inches [± 0.25 mm] unless otherwise specified

Product Specifications

Flex Voltage Version:

LED output		
LED color	Luminous intensity typ. (mcd)	I (mA)
red	1300-2700	20
soft yellow	80-400	20
yellow	450-1120	20
green	1000-1400	20
blue	280-710	20
white	1300-1800	20

120VAC Version:

LED output		
LED color	Luminous intensity typ. (mcd)	I (mA)
red	550	8
yellow	245	8
green	924	8
blue	67	8
white	644	8

Installation Specification

Mounting Hole	0.551" (14.0mm)
Panel Thickness	Up to .250" (6.3mm)
Spacing	minimum 1.5" center to center
Retainer Width	1" (25.4 mm)
Torque Specs	4-5 in/lbs

Temperatures

Operating Temperature	-40°F (-40°C) to 176°F (80°C)
Storage Temperature	-40°F (-40°C) to 212°F (100°C)

Materials

Body	polycarbonate, UL94-V2
Retaining Nut	PBT/Glass Filled, UL94-V0
Wire	24 AWG - Black/Red** 20 AWG - Black***
Lens	polycarbonate, UL94-V2
Moisture Seal	EPDM

** Flex Voltage Version

*** 120 VAC Version

Compliance and Approvals

