

This document is the property of Amphenol Corporation and is delivered on the express condition that it is not to be disclosed, reproduced or used, in whole or in part, for manufacture or sale by anyone other than Amphenol Corporation without its prior consent, & that no right is granted to disclose or to use any information in this document.

CUSTOMER DRAWING

REVISIONS

SYM	ECN	DESCRIPTION	DATE	APPROVED
1	CDXXXX	NEW RELEASE	SEP.25,2013	YH
2	CDXXXX	UPDATE DRAWING	SEP.26,2013	YH
3	CDXXXX	UPDATE DRAWING	NOV.22,2013	YH
4	CDXXXX	ADD A DIMENSION AND UPDATE DRAWING	APR.30,2014	YH

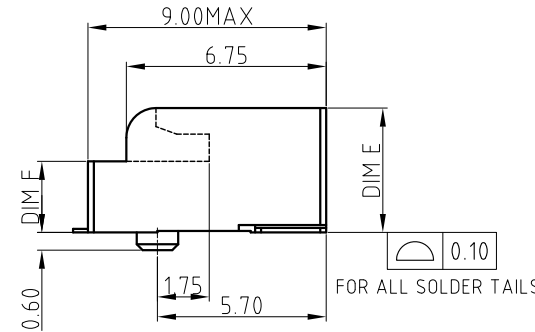
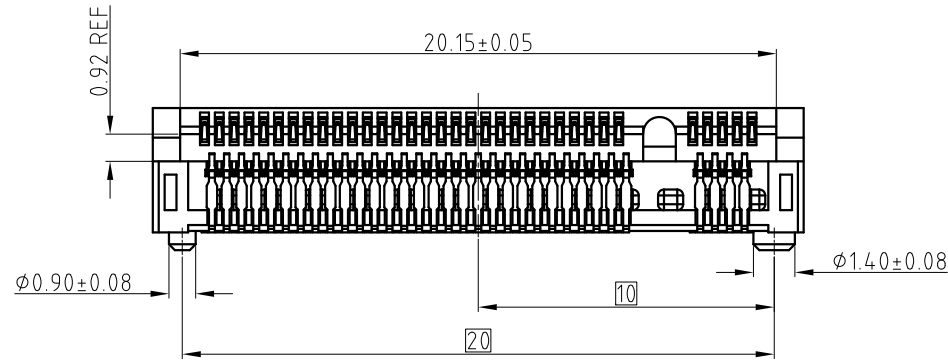
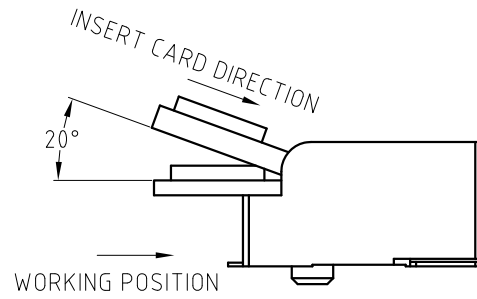
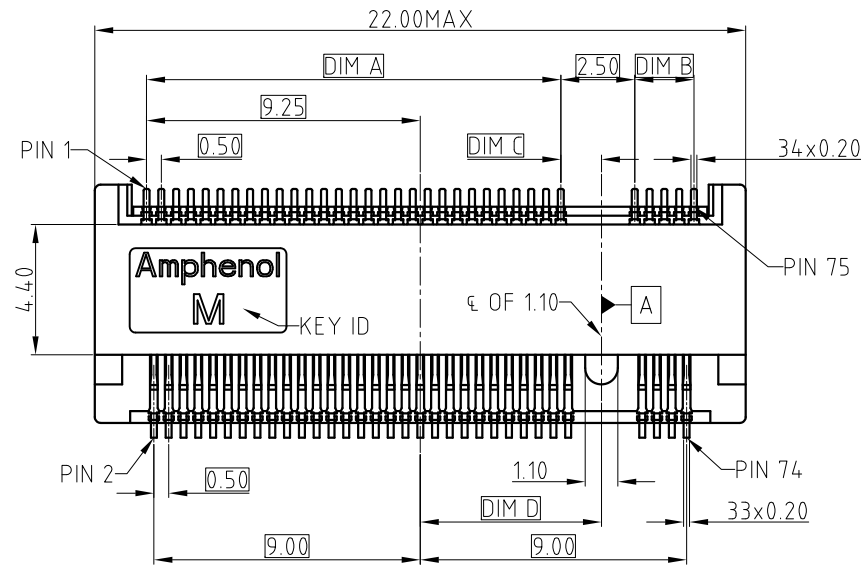

NOTE:

- MATERIAL:**
 PLASTIC: LCP, UL 94V-0, BLACK
 CONTACT: COPPER ALLOY
 BOARD LOCK: ALLOY
- FINISHED:**
 CONTACT AREA: SEE P/N SYSTEM
 SOLDER AREA: GOLD FLASH
 BOARD LOCK: TIN PLATING
 UNDERPLATED: NI PLATING
- ELECTRICAL PERFORMANCE:**
 3.1 CURRENT RATING: 0.5A PER PIN, VOLTAGE RATING: 50 VAC PER PIN
 3.2 DIELECTRIC STRENGTH: 300V AC FOR 1 MINUTE
 3.3 INSULATION RESISTANCE: 500MΩ MIN
 3.4 CONTACT RESISTANCE: 55mΩ MAX
 3.5 OPERATION TEMPERATURE: -40°C TO +80°C
- DIMENSIONING SHALL BE INTERPRETED PER ASME Y14.5M 1994**
- MATERIAL SHOULD BE FULFILLED AMPHENOL SPEC# S-SN-002 FOR HALOGEN FREE PRODUCTS, ALSO NEED TO MEET # S-SN-004**



ORDER P/N SYSTEM:

MDT XXX X XX 001

CONNECTOR HEIGHT

XXX	DIM E	DIM F
580	5.80MAX	4.14MAX
420	4.20MAX	2.54MAX
320	3.20MAX	1.54MAX
275	2.75MAX	0.89MAX
245	2.45MAX	0.61MAX

PLATING

- 01 0.76 MICRONS GOLD PLATING
- 02 0.38 MICRONS GOLD PLATING
- 03 GOLD FLASH

CONNECTOR KEY ID

- A - KEY A
- B - KEY B
- E - KEY E
- M - KEY M
- ...

PROPOSAL DRAWING

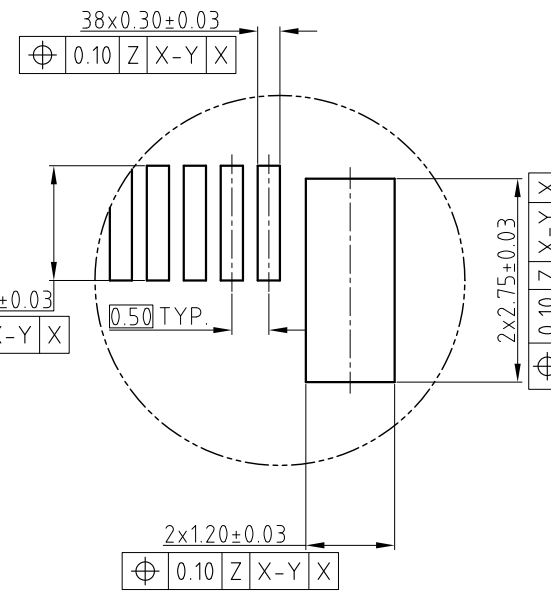
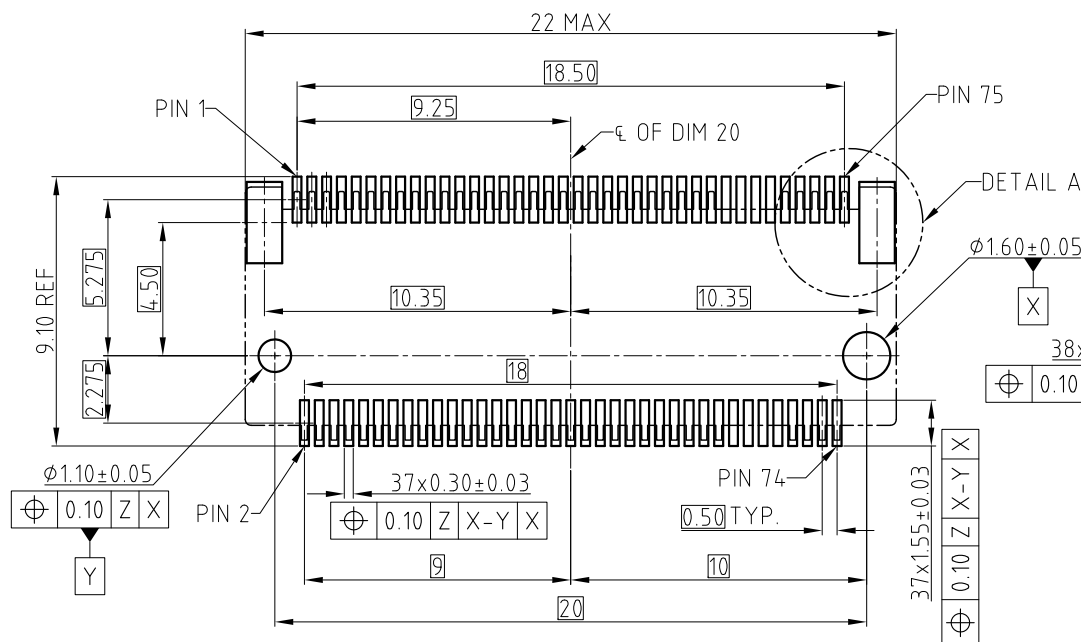

RECOMMENDED M.2 MINI CARD MOUNTING TYPE_SMT_PCB OUTLINE
 DATUM Z: PCB SOLDER SURFACE

DETAIL A
 SCALE 2.5:1

M	14.0	2.0	1.375	6.125	
E	5.5	10.5		-2.625	
B	2.5	13.5	1.125	-5.625	
A	1.5	14.5		-6.625	
KEY ID	DIM.A	DIM.B	DIM.C	DIM.D	REMARK

UNLESS OTHERWISE SPECIFIED TOLERANCES		APPROVAL		DATE	
U.S.	METRIC	DRAWN	Yunx.liu	APR.30,2014	
.X +/-	0.50	CHECKED	LY.YI	APR.30,2014	
.XX +/-	0.25	APPROVED			
.XXX +/-		DRAWING FILE :			
FRACTIONS +/-		DRAWING\MDT\CMDTXXXXXX001			
ANGLES +/-	5°	ANGLE OF PROJECTION			
REMOVE SHARP EDGES					
DIMENSIONS					
U.S.	INCHES				
(METRIC)	(MM)				

Amphenol		
TITLE		
M.2 MINI PCIe CONECTOR		
SIZE	DRAWING NO.	REV.
A3	C MDT-XXX-X-XX-001	4
SCALE	NONE	SHEET 1 OF 1