

1 | 2 | 3 | 4

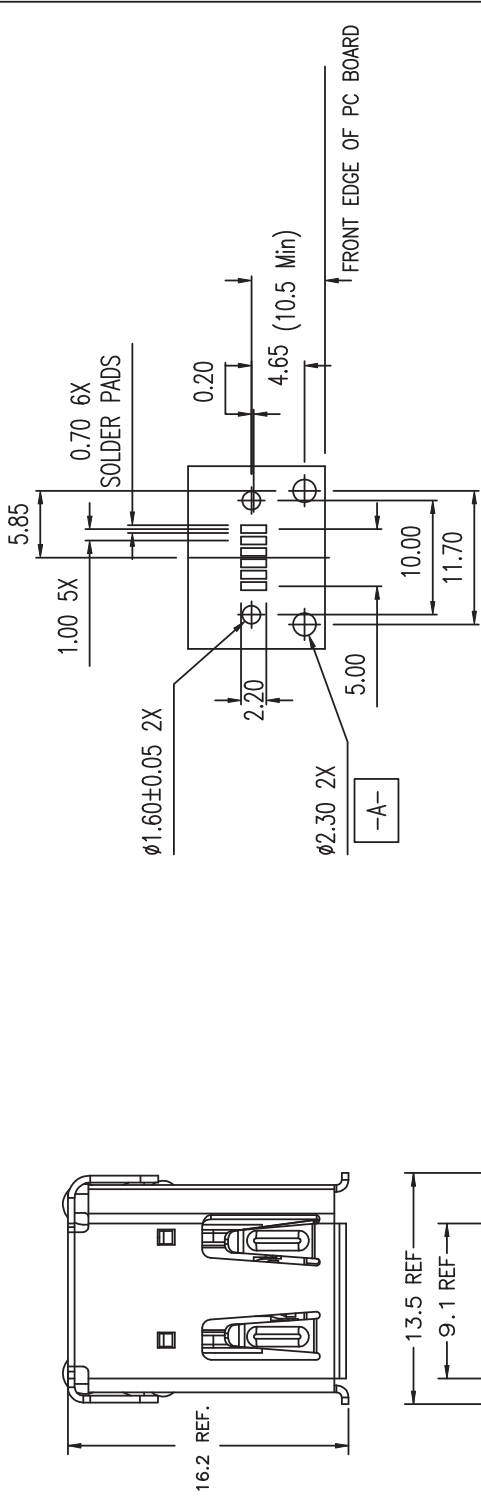

RECOMMENDED PCB LAYOUT

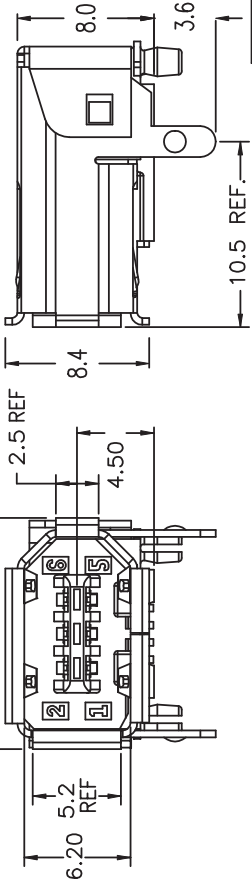

- NOTES:
1. DIMENSIONS AND TOLERANCES ARE IN ACCORDANCE WITH ASME Y14.5M, 1994.
  2. ALL HOLES AND PADS ON PCB  $\phi 0.10 \text{A}$
  3. RoHS COMPATIBLE PRODUCT, THE HOUSING WILL WITHSTAND EXPOSURE TO 260°C±5°C SOLDER BATH TEMPERATURE FOR 5 SECONDS IN A REFLOW SOLDER APPLICATION WITH A 1.6mm MIN THICK CIRCUIT BOARD.
  4. THIS PRODUCT MEETS EUROPEAN UNION DIRECTIVES AND OTHER COUNTRY REGULATIONS AS DESCRIBED IN GS-22-008.

THIS FILE WAS ORIGINALLY CREATED IN THE PRO ENGINEER ENVIRONMENT AND ANY FUTURE REVISIONS TO THIS FILE MUST BE MADE IN THE PRO ENGINEER ENVIRONMENT

P/N	CONTACT PLATING	SHIELD PLATING
73450-001/001LF	30u" GXT	80 u" TIN
73450-002/002LF	30u" GXT	50 u" NICKEL
73450-003/003LF	30u" GXT	80 u" TIN (DULL APPEARANCE)

mat'l code		SEE NOTES		tolerances unless otherwise specified		CUSTOMER		Electronics FCI	
itr	ecm no.	dr	date			copy	title	www.fciconnect.com	
A	V71806	GIP	12/4/97	linear	.X ±.3	projection	P1394		
B	V90138	R6D	02/17/99		.XX ±.20		ASSEMBLY		
C	V90164	LFT	03/25/99	angles	.XXX ±.100				
D	V92155	LEV4	05/04/00	dr	0° ±2°				
E	T00052	M W	09/20/00	enrg	G.PETERS 12/4/97	product family	P1394	code	213
F	T10200	M W	07/19/01	chr	R.MACHULLIN 12/4/97	size	73450	sheet	1 of 2
G	T05-0030	M W	02/16/05	oppd	R.MACHULLIN 12/4/97	scale	A	1 of 2	
sheet index	revision	G	G						
	index	1	2						

form no. 7530-001-103