

Hybrid

Outline

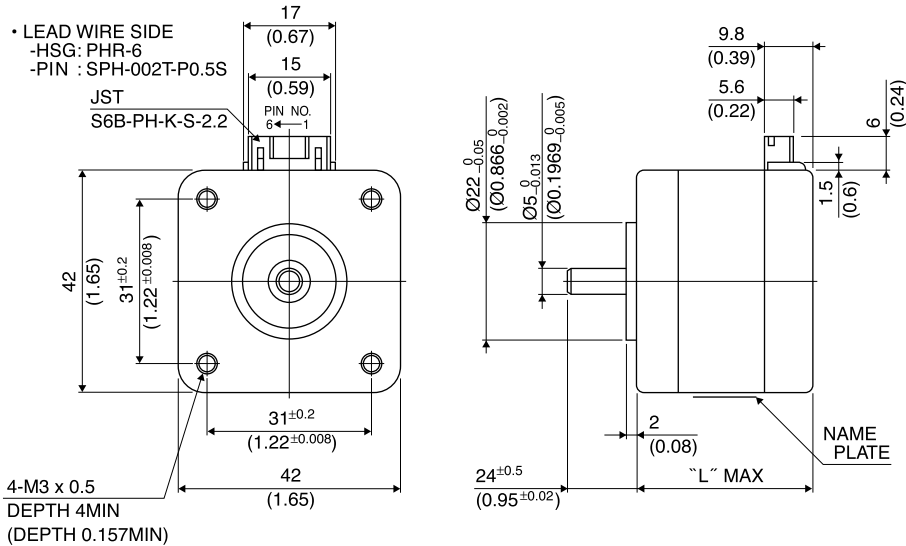

PIN NO. vs. PHASE

| PHASE | A | A COM | \bar{A} | B | B COM | \bar{B} |
|---------|---|-------|-----------|---|-------|-----------|
| PIN NO. | 4 | 5 | 6 | 3 | 2 | 1 |

| | "L" |
|-----------|-----------|
| 17PM-K7** | 26 (1.02) |
| 17PM-K2** | 30 (1.18) |
| 17PM-K0** | 34 (1.34) |
| 17PM-K3** | 38 (1.50) |
| 17PM-K1** | 42 (1.65) |
| 17PM-K4** | 48 (1.89) |
| 17PM-KA** | 60 (2.36) |

Specifications

| Model | Step Angle (deg) | Drive Sequence | Rated Current (A) | Resistance (Ohms) | Holding Torque (mNm) | Inductance (mH) | Rotor Inertia (g·cm ²) | Detent Torque (mNm) | Mass (g) |
|------------|---------------------|----------------|----------------------|----------------------|-------------------------|--------------------|---------------------------------------|------------------------|-------------|
| 17PM-K049U | 1.8 | UNI-POLAR | 1 | 3.2 | 200 | 3.2 | 37 | 11.0 | 200 |
| 17PM-K064U | 1.8 | UNI-POLAR | 0.6 | 8.3 | 200 | 8.1 | 37 | 11.0 | 200 |
| 17PM-K142U | 1.8 | UNI-POLAR | 1.4 | 2.3 | 280 | 3.2 | 62 | 11.8 | 300 |
| 17PM-K149U | 1.8 | UNI-POLAR | 1 | 4.3 | 280 | 6.0 | 62 | 11.8 | 300 |
| 17PM-K249U | 1.8 | UNI-POLAR | 0.8 | 2.7 | 100 | 3.0 | 24 | 4.3 | 180 |
| 17PM-K264U | 1.8 | UNI-POLAR | 0.6 | 6.9 | 100 | 7.4 | 24 | 4.3 | 180 |
| 17PM-K342U | 1.8 | UNI-POLAR | 1.4 | 2.0 | 250 | 2.5 | 50 | 11.3 | 250 |
| 17PM-K349U | 1.8 | UNI-POLAR | 1 | 3.6 | 250 | 4.7 | 50 | 11.3 | 250 |
| 17PM-K442U | 1.8 | UNI-POLAR | 1.4 | 2.8 | 400 | 3.4 | 75 | 16.7 | 350 |
| 17PM-K449U | 1.8 | UNI-POLAR | 1 | 4.9 | 400 | 6.5 | 75 | 16.7 | 350 |
| 17PM-K749U | 1.8 | UNI-POLAR | 0.9 | 2.2 | 50 | 0.4 | 11 | 2.8 | 150 |
| 17PM-K764U | 1.8 | UNI-POLAR | 0.6 | 5.6 | 50 | 1.0 | 11 | 2.8 | 150 |
| 17PM-KA39U | 1.8 | UNI-POLAR | 1.4 | 2.9 | 485 | 4.0 | 120 | 21.6 | 490 |
| 17PM-KA46U | 1.8 | UNI-POLAR | 1 | 5.6 | 485 | 8.1 | 120 | 21.6 | 490 |
| 17PM-K049B | 1.8 | BI-POLAR | 0.7 | 6.4 | 270 | 12.8 | 37 | 11.0 | 200 |
| 17PM-K142B | 1.8 | BI-POLAR | 1 | 4.6 | 380 | 12.9 | 62 | 11.8 | 300 |
| 17PM-K249B | 1.8 | BI-POLAR | 0.6 | 5.4 | 140 | 12.0 | 24 | 4.3 | 180 |
| 17PM-K342B | 1.8 | BI-POLAR | 0.9 | 4.0 | 310 | 9.9 | 50 | 11.3 | 250 |
| 17PM-K442B | 1.8 | BI-POLAR | 0.9 | 5.6 | 500 | 13.6 | 75 | 16.7 | 350 |
| 17PM-K749B | 1.8 | BI-POLAR | 0.6 | 4.4 | 65 | 1.6 | 11 | 2.8 | 150 |
| 17PM-KA39B | 1.8 | BI-POLAR | 1 | 6.0 | 610 | 15.9 | 120 | 21.6 | 490 |

Torque/Speed Characteristics

Model No: 17PM-K049U,K064U,K049B
 Driver: Chopper Dual
 Supply Voltage: 24.0 (Volt)

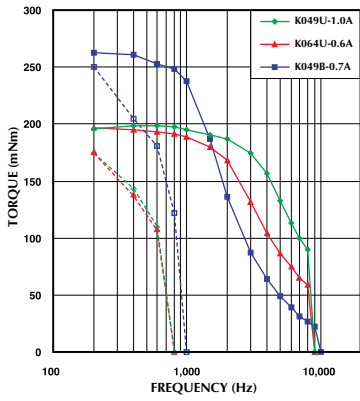

Model No: 17PM-K142U,K149U,K142B
 Driver: Chopper Dual
 Supply Voltage: 24.0 (Volt)

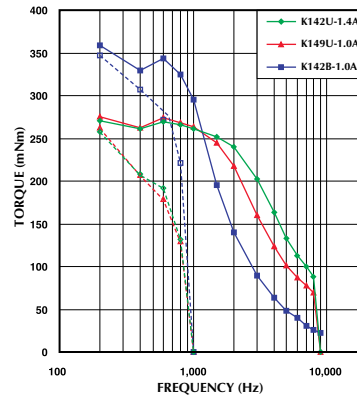

Model No: 17PM-K249U,K264U,K249B
 Driver: Chopper Dual
 Supply Voltage: 24.0 (Volt)

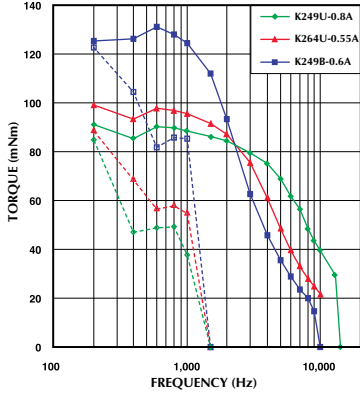

Model No: 17PM-K342U,K349U,K342B
 Driver: Chopper Dual
 Supply Voltage: 24.0 (Volt)

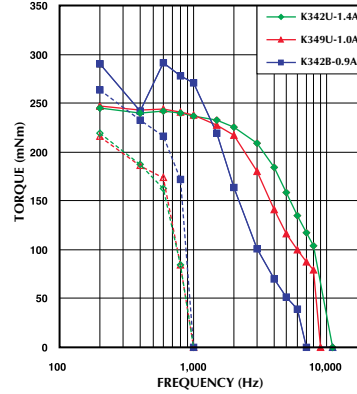

Model No: 17PM-K442U,K449U,K442B
 Driver: Chopper Dual
 Supply Voltage: 24.0 (Volt)

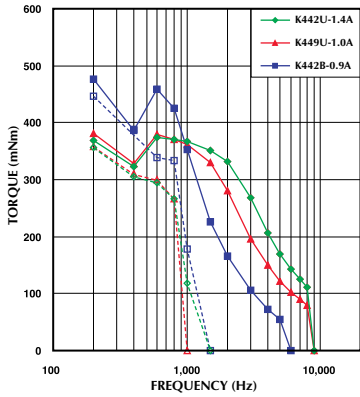

Model No: 17PM-K749U,K764U,K749B
 Driver: Chopper Dual
 Supply Voltage: 24.0 (Volt)

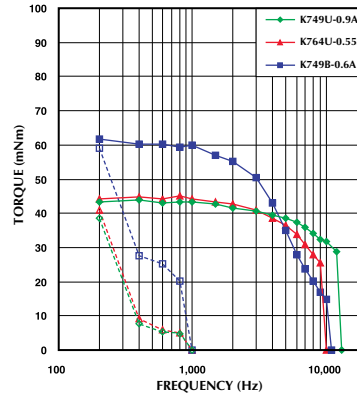

— : PULL OUT
 - - - : PULL IN

Model No: 17PM-KA39U,KA46U,KA39B
 Driver: Chopper Dual
 Supply Voltage: 24.0 (Volt)

