

NOTES

1. MATERIAL : BRASS(C2600), 0.4mm THICKNESS
2. FINISH : 0.8 -1.8 μ TIN PLATING OVERALL
0.3-0.8 μm COPPER PLATING
3. APPLICABLE SOCKET : 49454, 104035, 104036,
104037, 104038, 104039
4. APPLICABLE WIRE SEAL : 49454-9003
5. APPLICABLE S8 BULB :P27/7W
6. WIRE RANGE : AVS0.5~0.85SQ, FLY-A 0.75SQ

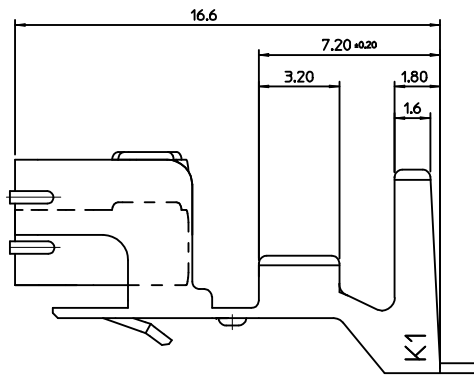

<TABLE 1>

MATERIAL NO.	ORDER NO.
498689702	49868-9702

NEW RELEASED EC NO: KTR2015-0117 DRWN:JKSE001 2015/06/16 CHKD: APPR:JYCH01 2015/06/22	DESCRIPTION REV	QUALITY SYMBOLS ▽=0 ◻=0	GENERAL TOLERANCES (UNLESS SPECIFIED) <table border="1"> <thead> <tr> <th></th> <th>mm</th> <th>INCH</th> </tr> </thead> <tbody> <tr> <td>4 PLACES</td> <td>± ---</td> <td>± ---</td> </tr> <tr> <td>3 PLACES</td> <td>± 0</td> <td>± ---</td> </tr> <tr> <td>2 PLACES</td> <td>± 0.20</td> <td>± ---</td> </tr> <tr> <td>1 PLACE</td> <td>± 0.25</td> <td>± ---</td> </tr> </tbody> </table>		mm	INCH	4 PLACES	± ---	± ---	3 PLACES	± 0	± ---	2 PLACES	± 0.20	± ---	1 PLACE	± 0.25	± ---	DIMENSION STYLE MM ONLY	SCALE 5:1	DESIGN UNITS METRIC	THIRD ANGLE PROJECTION
			mm	INCH																		
		4 PLACES	± ---	± ---																		
		3 PLACES	± 0	± ---																		
2 PLACES	± 0.20	± ---																				
1 PLACE	± 0.25	± ---																				
DRAWN BY SMK1M	DATE 2009/03/16	TITLE S8 DOUBLE TERMINAL																				
CHECKED BY BCY00N	DATE 2009/03/16	MOLEX INCORPORATED																				
APPROVED BY EHJUNG	DATE 2009/03/16	MATERIAL NO. SEE TABLE1	DOCUMENT NO. SD-49868-001	SHEET NO. 1 OF 1																		

DRAFT WHERE APPLICABLE
MUST REMAIN
WITHIN DIMENSIONS

THIS DRAWING CONTAINS INFORMATION THAT IS PROPRIETARY TO MOLEX INCORPORATED AND SHOULD NOT BE USED WITHOUT WRITTEN PERMISSION