

LOC J	DIST /	REVISIONS 変更			DATE	DWN	APVD
P	LTR	DESCRIPTION			22SEP2010	T.T	T.M
	A	REVISED	ECR-10-019664				

-1; AS SHOWN

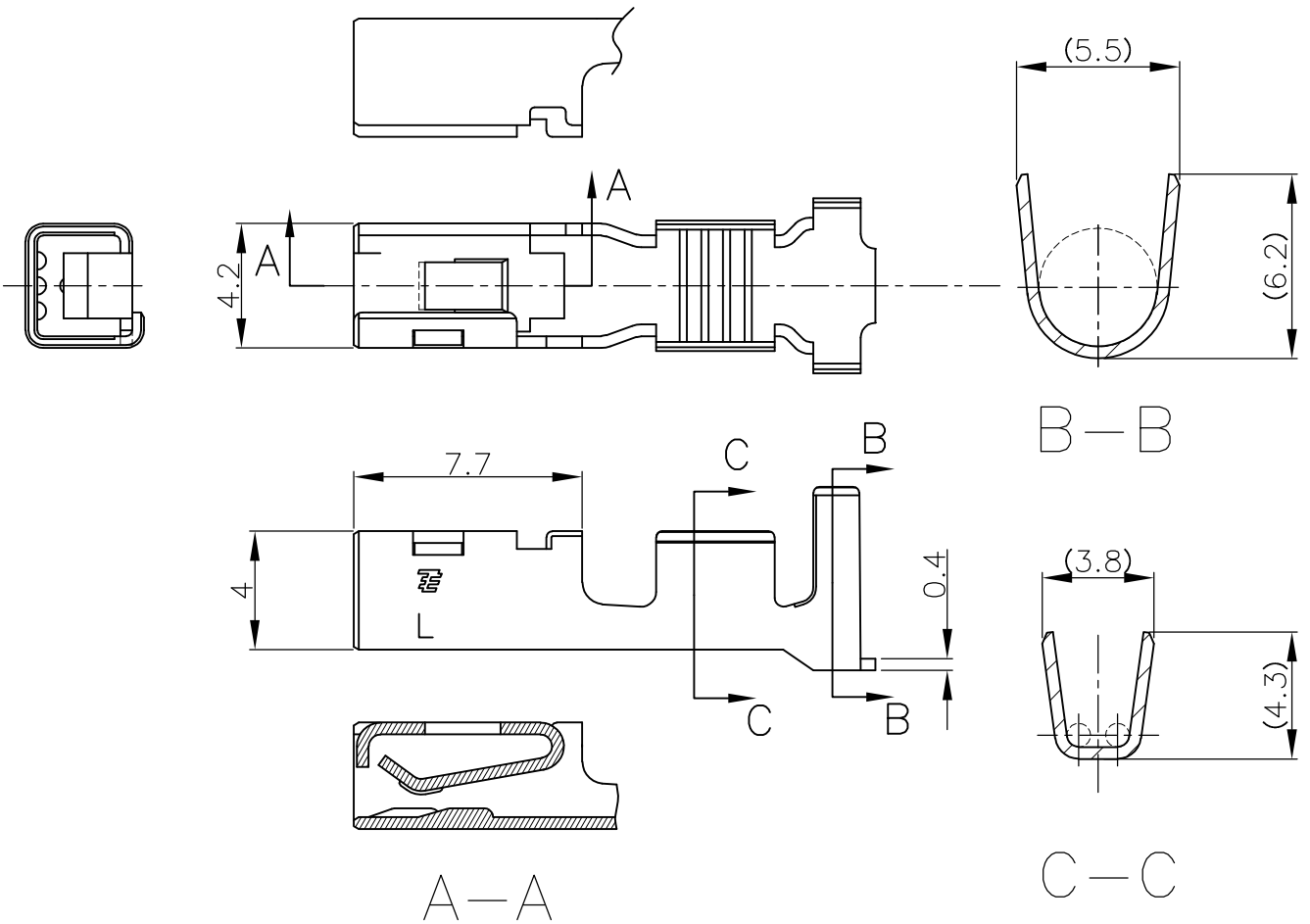

- 1 一般公差 : ±0.25
- 2 材料 : 錫めっき済 銅合金
- 3 適用電線 : AWG #14-#12 (被覆外径φ2.9~φ4.1)

- 1 GENERAL TOLERANCE: ±0.25
- 2 MATERIAL: PRE-TIN COPPER ALLOY
- 3 APPLICABLE WIRE: AWG #14-#12 (INS DIAφ2.9~φ4.1)

L TYPE

1746972-1
PART NUMBER

THIS DRAWING IS UNPUBLISHED. MAY, 2004. ALL INTERNATIONAL RIGHTS RESERVED. BY TYCO ELECTRONICS CORPORATION. COPYRIGHT 2004

DIMENSIONS:
単位: 耗
mm

DWN A.OISHI 17MAY2004

MATERIAL
材料

FINISH
仕上

CHK N.YAMASAKI 17MAY2004



Tyco Electronics Corporation
Kawasaki, Japan

APVD N.YAMASAKI 17MAY2004

PRODUCT SPEC
製品規格
108-5979

NAME
名称
GRACE INERTIA CONNECTOR 6.2MM PITCH
REC CONTACT, L TYPE

APPLICATION SPEC
取付適用規格
114-5356

SIZE A4 CAGE CODE 00779 DRAWING NO 番号 1746972

WEIGHT

CUSTOMER DRAWING

SCALE 尺度 4:1

SHEET 1 OF 1

REV A

TOLERANCES UNLESS OTHERWISE SPECIFIED:
一般公差

0 PLC	± -
1 PLC	± -
2 PLC	± -
3 PLC	± -
4 PLC	± -
ANGLES	± 2°

