

PART DESCRIPTIONS

04

| NOMINAL SIZE | DIMENSION        |                         |                         |                         |                                    | BUNDLE RANGE                   | PART NUMBER (SEE NOTE 1) |
|--------------|------------------|-------------------------|-------------------------|-------------------------|------------------------------------|--------------------------------|--------------------------|
|              | A                | B                       | C                       | D                       | E                                  |                                |                          |
|              | REF              | $\pm .008$<br>$\pm .20$ | $\pm .010$<br>$\pm .25$ | $\pm .020$<br>$\pm .51$ |                                    |                                |                          |
| 1/8          | .125<br>[3.18]   | .032<br>[.81]           | .134<br>[3.40]          | .061<br>[1.55]          | .187 +/- .062<br>[4.75 +/- 1.58]   | .063 to .500<br>[1.60 to 12.7] | 1NFP_                    |
|              |                  | .015<br>[.38]           | .176<br>[4.47]          | .095<br>[2.41]          | .187 +/- .062<br>[4.75 +/- 1.58]   |                                | 1FRP_                    |
|              |                  | .020<br>[.51]           | .169<br>[4.29]          | .085<br>[2.16]          | .187 +/- .062<br>[4.75 +/- 1.58]   |                                | 1N_                      |
|              |                  |                         |                         |                         |                                    |                                | 1P_                      |
| 1/4          | .250<br>[6.35]   | .045<br>[1.14]          | .301<br>[7.65]          | .160<br>[4.06]          | .375 +/- .125<br>[9.53 +/- 3.17]   | .188 to 2.00<br>[4.75 to 50.8] | 2NFP_                    |
|              |                  | .025<br>[.63]           | .324<br>[8.23]          | .200<br>[5.08]          | .375 +/- .125<br>[9.53 +/- 3.17]   |                                | 2FRP_                    |
|              |                  | .030<br>[.76]           | .318<br>[8.08]          | .190<br>[4.83]          | .375 +/- .125<br>[9.53 +/- 3.17]   |                                | 2N_                      |
| 3/8          | .375<br>[9.53]   | .052<br>[1.32]          | .389<br>[9.88]          | .271<br>[6.88]          | .438 +/- .125<br>[11.13 +/- 3.17]  | .313 to 3.00<br>[7.92 to 76.2] | 2.5NFP_                  |
|              |                  | .035<br>[.89]           | .398<br>[10.11]         | .305<br>[7.75]          | .438 +/- .125<br>[11.13 +/- 3.17]  |                                | 2.5FRP_                  |
|              |                  | .030<br>[.76]           | .401<br>[10.19]         | .315<br>[8.00]          | .438 +/- .125<br>[11.13 +/- 3.17]  |                                | 2.5N_                    |
| 1/2          | .500<br>[12.70]  | .062<br>[1.57]          | .508<br>[12.90]         | .376<br>[9.55]          | .563 +/- .125<br>[14.30 +/- 3.17]  | .375 to 4.00<br>[9.52 to 102]  | 2.5P_                    |
|              |                  | .035<br>[.89]           | .470<br>[11.94]         | .430<br>[10.92]         | .500 +/- .125<br>[12.70 +/- 3.17]  |                                | 3FRP_                    |
|              |                  | .030<br>[.76]           | .521<br>[13.23]         | .440<br>[11.18]         | .500 +/- .125<br>[12.70 +/- 3.17]  |                                | 3NFP_                    |
| 3/4          | .750<br>[19.05]  | .065<br>[1.65]          | .700<br>[17.78]         | .620<br>[15.75]         | .750 +/- .250<br>[19.05 +/- 6.35]  | .750 to 5.00<br>[19.10 to 127] | 3N_                      |
|              |                  | .032<br>[.81]           | .708<br>[17.98]         | .686<br>[17.42]         | .750 +/- .250<br>[19.05 +/- 6.35]  |                                | 4NFP_                    |
|              |                  | .032<br>[.81]           | .808<br>[20.52]         | .686<br>[17.42]         | .750 +/- .250<br>[19.05 +/- 6.35]  |                                | 4FRP_                    |
| 7/8          | .825<br>[20.96]  | .032<br>[.81]           | .828<br>[21.03]         | .811<br>[20.60]         | .875 +/- .250<br>[22.23 +/- 6.35]  | .500 to 5.00<br>[12.70 to 127] | 4N_                      |
|              |                  |                         |                         |                         |                                    |                                | 4P_                      |
|              |                  |                         |                         |                         |                                    |                                |                          |
| 1            | 1.000<br>[25.40] | .080<br>[2.03]          | .931<br>[23.65]         | .840<br>[21.34]         | 1.000 +/- .250<br>[25.40 +/- 6.35] | .630 to 6.00<br>[16.00 to 152] | 4.5N_                    |
|              |                  | .032<br>[.81]           | .947<br>[24.05]         | .936<br>[23.77]         | 1.000 +/- .250<br>[25.40 +/- 6.35] |                                | 5NFP_                    |
|              |                  | .040<br>[1.02]          | .945<br>[24.00]         | .920<br>[23.37]         | 1.000 +/- .250<br>[25.40 +/- 6.35] |                                | 5FRP_                    |
|              |                  |                         |                         |                         | .750 to 5.00<br>[19.10 to 127]     | 5N_                            |                          |
|              |                  |                         |                         |                         |                                    | 5P_                            |                          |

NOTES:

1. MATERIAL DEFINITION AND APPROVALS:

- NFP: NON-FLAME RETARDANT POLYETHYLENE
- MIL I-631D
  - MIL P-21922B
  - MIL A-A-59602 TYPE I
  - FED SPEC LP390C

- FRP: FLAME RETARDANT POLYETHYLENE
- NONE

- N: NYLON
- MIL A-A-59602 TYPE II
  - AS1294

- P: P.T.F.E. - TEFLON
- MIL I-22129C
  - MIL A-A-59602 TYPE III
  - AMS 3653C
  - AMS 3654
  - AMS 3655
  - ASTM D3295
  - ASTM D1710
  - AS1294

2. CUSTOM CUT LENGTH TOLERANCE  $\pm .25$ [6.35]

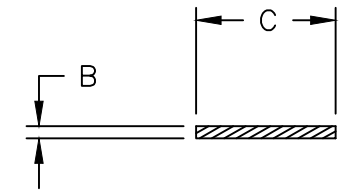
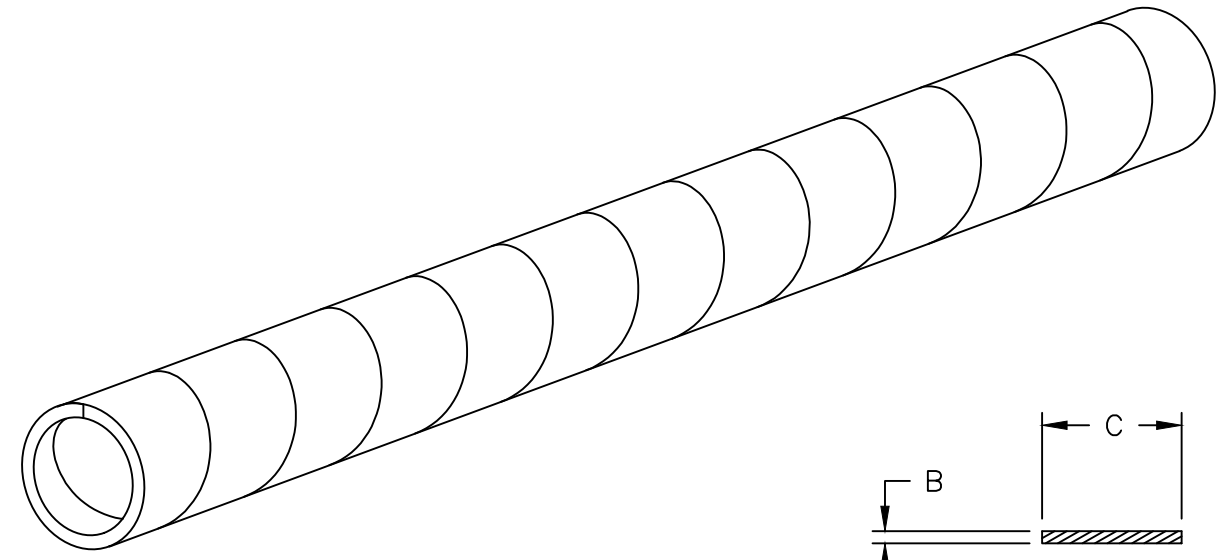

SECTION Z-Z

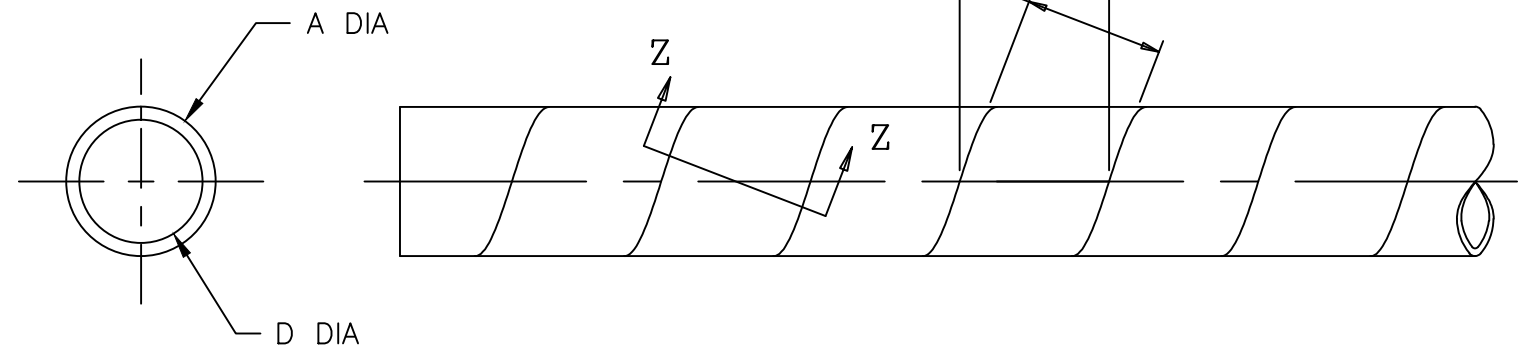

PART NUMBER DESCRIPTION:

1NFP\_ CUSTOM CUT LENGTH (CONSULT FACTORY FOR QUOTE - SEE NOTE 2)  
 COLOR (CONSULT FACTORY FOR AVAILABLE COLORS)

REDUCED  
NO SCALE

**Hellemanntyton.**

ALL PROPRIETARY RIGHTS IN THE SUBJECT MATTER SHOWN ON THIS DRAWING ARE EXCLUSIVE PROPERTY OF HELLERMANNITYTON

| name | date | city, state |
|------|------|-------------|
|      |      |             |
|      |      |             |

NOTES

REVISIONS

| level | date     | by  | ECN #  | part level |
|-------|----------|-----|--------|------------|
| 04    | 04/08/16 | GRW | 013417 | -          |

TOLERANCES  
 .XXXX= UNLESS OTHERWISE SPECIFIED  
 .XXX= NOTED  
 .XX= NOTED  
 .X= UNLESS OTHERWISE SPECIFIED  
 ∠= UNLESS OTHERWISE SPECIFIED  
 units inches/[mm]

PART

|          |            |       |            |
|----------|------------|-------|------------|
| number   | SEE CHART  | phase | PRODUCTION |
| name     | SPIRALWRAP |       |            |
| material | SEE NOTE 1 |       |            |

DRAWING

|                      |                   |         |              |          |
|----------------------|-------------------|---------|--------------|----------|
| FORMAT B version M   | CAD               | ACAD    | scale        | 1X       |
| computer file number | DT\SER\2005100_04 |         |              |          |
| previous number      |                   |         |              |          |
| drawn                | G.G.G.            | checked | K.A.C.       | approved |
| date                 | 01/07/93          | date    | 07/27/06     |          |
| type                 | SERIES            |         | sheet 1 of 1 |          |
| number               | DT2005100SER      |         |              |          |