

PRODUCT NUMBER	PITCH
YExx21x100J0G	5.08mm

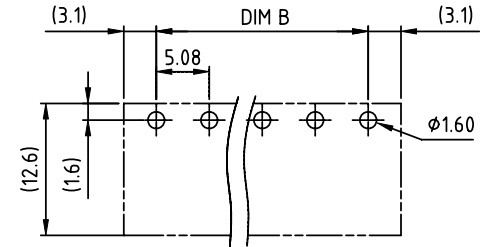

RECOMMENDED P.C.B LAYOUT
TOP VIEW

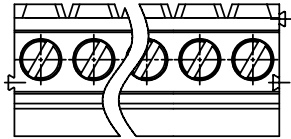
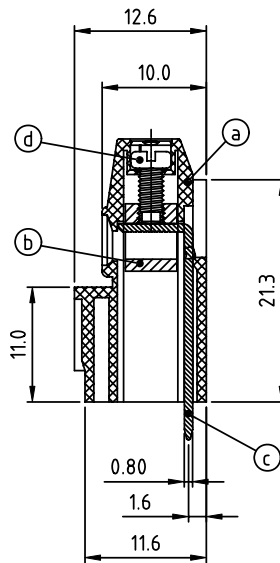
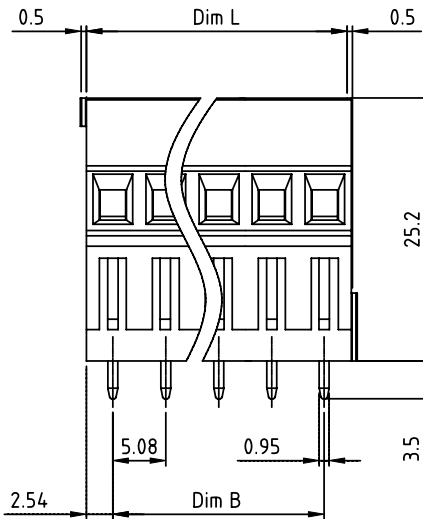

Material:

- Item (a) Terminal housing: Thermoplastic (UL 94V-0)
- Item (b) Clamp: Brass, Ni plated
- Item (c) Solder pin: Brass, Tin plated
- Item (d) Terminal screw: Steel, Zinc plating"-slot type

Electrical cULus

- Voltage rating: 300VAC
- Current rating: 10A
- Wire range:
 - Solid wire(AWG): 12-24
 - Stranded wire(AWG): 12-24
- Torque(Lb-In): 3.5
- Screw: M2.5
- Wire strip length: 6-7mm
- Withstanding Voltage: 1.6KV
- Operating temperature: -40°C to +115°C
- Soldering temperature: 260°C±5°C/5 Sec
- Safety Approval:

DIMENSION

Dim L	Nx5.0
Dim B	(N-1)x5.0

N=Number of poles

Poles	Tolerance
4p~6p	±0.15
7p~12p	±0.25
13p~18p	±0.35
19p~24p	±0.40

PART NO.: YE xx 2 1 x 1 00J0 G

Solid block	0	Color	2	RoHS compliant	(lead<4%)
No. of poles	2	Black (RAL9005)		In copper Alloy	
04 4 poles	3	Red (RAL3001/D)			
05 5 poles	4	Orange(RAL2011/P)			
...	5	Yellow(RAL1018/A)			
24 24 poles	6	Green(RAL6018/T)			
	7	Blue (RAL5015/A)			
	8	Grey(RAL7035/D)			
	9	White(RAL1102)			
	C	Green(RAL6018/U)			

mat'l. code		surface ASME Y14.5 ✓	tolerance ASME Y14.5	projection 	product family TERMINAL BLOCK
ltr	ecn no	dr	date	tolerances unless otherwise specified	title
				angles $X \pm 0.5$	TERMINAL BLOCK
				$X.X \pm 0.3$	RISING CLAMP, 180D WIRE INLET, SOLID BLOCK
				$X.XX \pm 0.1$	scale
		dr	EVIN ZHONG	041014	
		enrg	EVIN ZHONG	041014	
		chr	HANKE FENG	041014	
		appd	SHI JUN	041014	
sheet index	revision sheet	A	1		YExx21x100J0G sheet 1 of 1 size A4 type CUSTOMER Drawing